

RENOFIX 5 WHITE

CONSTRUCTION GLUE
CEMENT LEVELLING MATERIAL

Please follow the technical instructions!

AREA OF APPLICATION:

Used for affixation of insulation boards (polystyrene and silicate cotton) as leveling material of concrete surfaces as well as a tier for smooth concrete surfaces, ceramic, stone tiles and granite boards.

COMPOSITION:

- Cement
- High-quality rocky lime
- Processing improvement additives

FEATURES:

- Good base contact
- Excellent quality of processing

BASE PREPARATION:

The base must be dry and cleaned from dust, waste and oils (sheath oils). The processing instructions match bases built in line with certain norms and presuppose closed joints. In case of any open joints and cracks in the wall, these need to be closed first.

MORTAR PREPARATION:

Use a mixer to mix one bag of Renofix 5 with 6-6.5 litres of clean water until the mass becomes homogenous and lump-free.

PROCESSING AND PROCESSING CONDITIONS:

The mixed material is applied or poured with a trowel, smoothed as glue with the coarse side of the trowel. During the binding process, good drying and hardening conditions (by way of draught) need to be ensured. The mortar is to be freshly applied within 2 hours. **It must not be used at temperatures lower than +5°C.** It is not to be mixed with other materials.



WARNING:

Contains cement and lime. Irritates the skin and the eyes. In case of skin contact, rinse with clean water.

DELIVERY:

Delivered in 25 kg paper bags protected against moisture.



STORAGE:

To be stored in dry space, on top of wooden pallets. Storage time – 6 months.

Technical data	
Product no.:	5319990620033
Product code:	1005 B
Bags on a pallet:	42
Unit quantity:	25 kg bag
Granulation:	0,6 mm

RENOFIX 5 WHITE

Amount of water required:	6-6,5 l / bag
Minimum layer thickness:	3 / 5 mm
Consumption:	4 kg per m ² for tile affixing and 3 kg per m ² for net gluing
Note:	Consumption figures are approximate and depend to a large extent on the base and installation method
Material density, if dry (EN 1015-10):	ca. 1.600 kg/m ³
Hardness under pressure for 28 days (EN 1015-11):	ca.12 N / mm ²
Hardness under bending for 28 days (EN 1015-11):	ca.5.5 N / mm ²

General instructions:



All data about the material cease to be valid following the issuance of the above list. These are the data resulting from our current analyses. No legal obligation may arise from these data. The RENOVA products, as well as all raw materials contained in them are subject to constant, continuous tests to ensure constant and same level quality. Our technical advisers are at your disposal for any inquiries regarding the application, processing, and presentation of our products. You may find our current data at www.renova.com.mk, as a  document or ask for them in the retail shops.

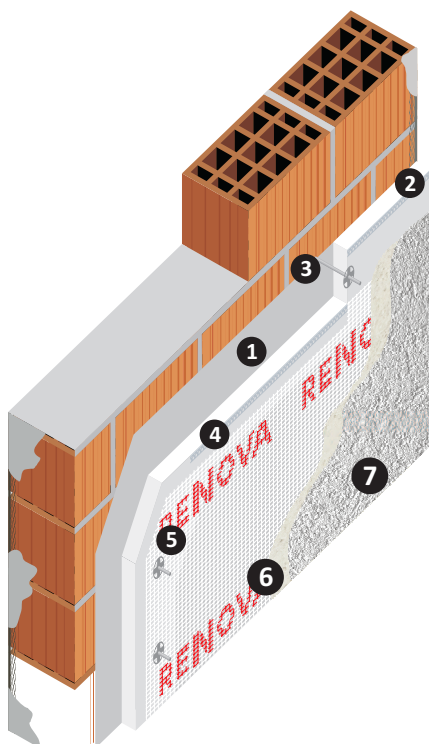

- 1 RENOFIX 5 White
- 2 Polystyrene and silicate cotton
- 3 Polystyrene joints
- 4 RENOFIX 5 White
- 5 Reinforcement net
- 6 RENOFIX 5 White
- 7 Final layer serial 370/700/740

RENOVA PUTZ | www.renova.com.mk

RENOVA Dzepeiste, Tetovo, Makedonija | Tel.: 044 487 300 | Fax: 044 487 200 | info@renova.com.mk
 RENOVA Gureza, Urosevac, Kosovo | Tel.: 00381 290 323 311 | Fax: 00381 290 396 396 | renova_ferizaj@hotmail.com
 RENOVA Vore, Tirana, Albanija | Tel.: 00355 48 301 909 | Fax: 00355 48 301 908 | renova.tirana@hotmail.com